



TRUE BLUE[®] BATH WASTE CONTRACTOR KIT

Job Name _____	Item # _____
Location _____	
Engineer _____	Contractor _____
PO # _____	Tag _____
Representative _____	

SPECIFICATIONS

The Dearborn True Blue Bath Waste contractor kits shall be used in applications requiring a bath waste and overflow drain with integrated test features. Overflow gasket shall be made of a high memory foamed rubber. Drain gasket shall be notched and undercut to wrap around drain elbow and lock into place. This will prevent gasket from being knocked off during installation and remain secured to drain elbow regardless of orientation. Test plugs shall be removable and reusable. Angle adapter and sanitary tee shall be included in kits for contractor convenience. Faceplate installation shall not require additional tools or screws; symmetrical design will eliminate the need for precise alignment. Contractor kits to be provided complete with Chrome plated stopper and overflow cover plate. Trim kits shall include one stopper and one overflow cover plate.

APPROVALS AND LISTINGS

ASME A112.18.2-2015/CSA B125.2-15



Uniform Plumbing Code (UPC[®])



National Plumbing Code of Canada



International Plumbing Code (IPC[®])



ASME A112.18.2-2015/CSA B125.2-15

FEATURES AND MATERIALS

Finish Trim	Tool-Free, Screw-Free Installation
Test Plugs	Reusable Tool-Free Installation
Drain Gasket	Locking Rubber Gasket
Overflow Gasket	High Memory Foamed Rubber
Spud	430 Stainless Steel

PERFORMANCE SPECIFICATIONS

Test Plug Rating	40 FT Head, 17 PSI
Flow Rate	10.95 GPM

DIMENSIONS

[A]:	Drain / Spud Thread	1-1/2" – 11.5 NPSM
[B]:	Inner Diameter	1-1/2" SCH 40 Pipe
[C]:	Outer Diameter	1-1/2" SCH 40 Pipe
[D]:	Overflow Depth	1.236"

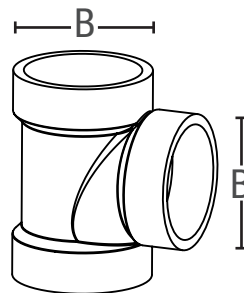
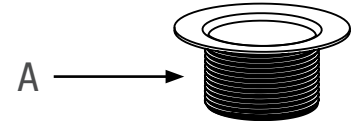
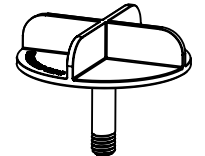
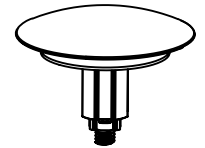
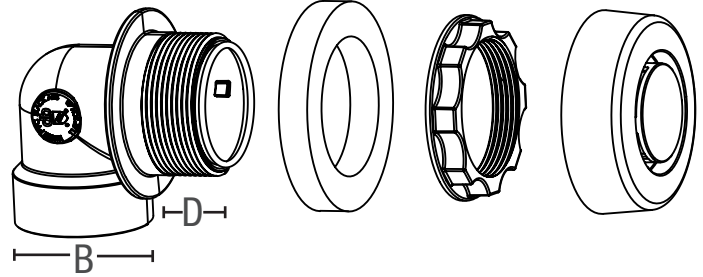

INDIRECT DRAIN

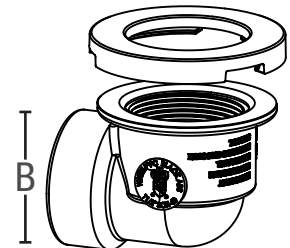

INDIRECT DRAIN

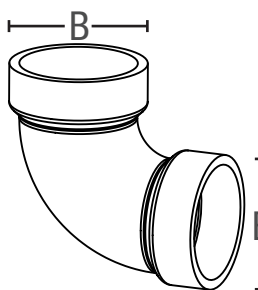

DIRECT DRAIN

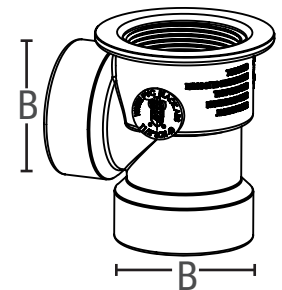

DIRECT DRAIN



TRUE BLUE® BATH WASTE CONTRACTOR KIT

PRODUCT SELECTOR

TRUE BLUE® BATH WASTE CONTRACTOR KIT								
✓	Product Number	Material	Stopper Style	Finish	Drain Spud Material	Test Plug Included	Overflow Cover Included	Drain Orientation
	TBCA9980	ABS	Low Profile Dome	Chrome	430 Stainless Steel	No	Yes	Indirect
	TBCA9980T	ABS	Low Profile Dome	Chrome	430 Stainless Steel	Yes	Yes	Indirect
	TBCA9980CPD	ABS	Low Profile Dome	Chrome	430 Stainless Steel	No	Yes	Direct
	TBCA9980CPDT	ABS	Low Profile Dome	Chrome	430 Stainless Steel	Yes	Yes	Direct
	TBCA9980U	ABS	Low Profile Dome	Chrome	430 Stainless Steel	Yes	Yes	Indirect/Direct
	TBCA9980PVCU	PVC	Low Profile Dome	Chrome	430 Stainless Steel	Yes	Yes	Indirect/Direct

TRUE BLUE® BATH WASTE CONTRACTOR ROUGH-IN KIT								
✓	Product Number	Material	Stopper Included	Finish	Drain Spud Material	Test Plug Included	Overflow Cover Included	Drain Orientation
	TBCA9975RIT	ABS	No	Chrome	430 Stainless Steel	Yes	No	Indirect
	TBCA9975RI	ABS	No	Chrome	430 Stainless Steel	No	No	Indirect

TRUE BLUE® BATH WASTE CONTRACTOR TRIM KIT				
✓	Product Number	Stopper Style	Finish	Overflow Cover Included
	TBCK90CP	Low Profile Dome	Chrome	Yes
	TBCK90BN	Low Profile Dome	Brushed Nickel	Yes
	TBCK90MB	Low Profile Dome	Matte Black	Yes
	TBCK90BG	Low Profile Dome	Brushed Gold	Yes
	TBCK90CB	Low Profile Dome	Champagne Bronze	Yes
	TBCK90WH	Low Profile Dome	White	Yes

TRUE BLUE® BATH WASTE CONTRACTOR TEST KIT			
✓	Product Number	Quarter Turn Overflow Test Plug Included	Threaded Post Spud Test Plug Included
	TBCTEST	Yes	Yes