



TRUE BLUE® BATH WASTE BRASS FULL KIT W/ SLIP JOINT CONNECTION & NY TEE

| | |
|----------------------|------------------|
| Job Name _____ | Item # _____ |
| Location _____ | |
| Engineer _____ | Contractor _____ |
| PO # _____ | Tag _____ |
| Representative _____ | |

SPECIFICATIONS

The Dearborn True Blue Bath Waste shall be used in commercial and residential applications requiring a bath waste and overflow drain with integrated test features. Overflow and drain elbow components shall come factory preassembled for added convenience. Overflow, Tee and Drain Pipe Connections will be Slip Joint Connections. Tee shall allow to be plumbed vertically or horizontally and feature inner threads. Overflow gasket shall be made of a high memory foamed rubber. Drain gasket shall be notched and undercut in order to wrap around drain elbow and lock into place. This will prevent gasket from being knocked off during installation and remain secured to drain elbow regardless of orientation. Test plugs shall be quarter turn installation and must be removable and reusable. Overflow test plug shall be used to install the designer trim veneer with a quarter turn and will not require additional tools or sealants for installation. Faceplate installation shall not require additional tools or screws, symmetrical design will eliminate the need for precise alignment.

APPROVALS AND LISTINGS

ASME A112.18.2-2015/CSA B125.2-15



Uniform Plumbing Code (UPC®)



International Plumbing Code (IPC®)



ASME A112.18.2-2015/CSA B125.2-15

Listed with Massachusetts Board of Plumbing

FEATURES AND MATERIALS

| | |
|-----------------|--|
| Finish Trim | Tool-Free, Screw Free Installation |
| Test Plugs | Reusable, Quarter Turn Tool-Free Installation |
| Drain Gasket | Locking Rubber Gasket |
| Overflow Gasket | High Memory Foamed Rubber |
| Spud | Chrome Plated Brass |
| NY Lay Down Tee | Plumb vertically or horizontally, includes inner threads |

PERFORMANCE SPECIFICATIONS*

| | |
|--------------------|--|
| Test Plug Rating | 40 FT Head, 17 PSI |
| Drain Flow Rate | Min. 7 GPM Max. 15.8 GPM depending on finish |
| Overflow Flow Rate | 4.40 GPM |

*Contact Technical@Oatey.com for specific flow rates.

DIMENSIONS

| | | |
|------|---------------------|----------------------------------|
| [A]: | Overflow Height | 11.5" (20" For Whirlpool PNs) |
| [B]: | Drain Pipe Depth | 5.66" (11.16" For Whirlpool PNs) |
| [C]: | Inner Diameter | 1.5" |
| [D]: | Overflow Depth | 1.24" |
| [E]: | Drain / Spud Thread | 1.5" – 11.5 NPSM |

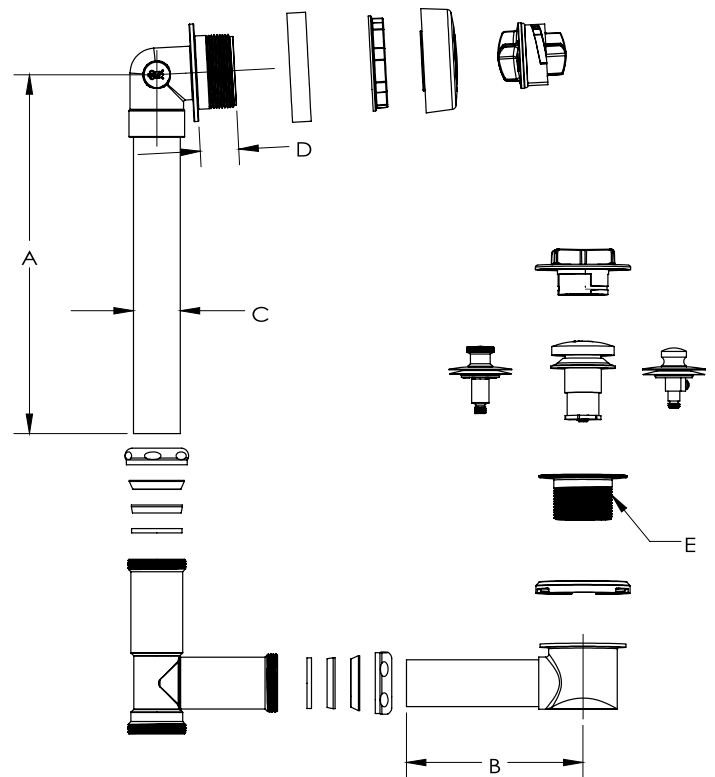

Access BIM/Revit content through www.oatey.com



TRUE BLUE® BATH WASTE BRASS FULL KIT W/ SLIP JOINT CONNECTION & NY TEE

PRODUCT SELECTOR

| TRUE BLUE® BATH WASTE BRASS FULL KIT W/ SLIP JOINT CONNECTION & NY TEE | | | | | | |
|--|----------------|-------------|---------------|--------|-----------------|-----------|
| ✓ | Product Number | Brass Gauge | Stopper Style | Finish | Faceplate Style | Length |
| | 18850CPNY | 17 | Touch Toe | Chrome | Standard | Standard |
| | 78950CPNY | 17 | Touch Toe | Chrome | Standard | Whirlpool |
| | 8850CPNY | 20 | Touch Toe | Chrome | Standard | Standard |
| | 8950CPNY | 20 | Touch Toe | Chrome | Standard | Whirlpool |

| TRUE BLUE® BATH WASTE TRIM KIT | | | | | | | |
|--------------------------------|----------------|---------------|-------------------|---|----------------|---------------|-------------------|
| ✓ | Product Number | Stopper Style | Finish | ✓ | Product Number | Stopper Style | Finish |
| | K97WH | Touch Toe | White | | K98WH | Uni-Lift | White |
| | K97MB | Touch Toe | Matte Black | | K98MB | Uni-Lift | Matte Black |
| | K97CP | Touch Toe | Chrome | | K98BG | Uni-Lift | Brushed Gold |
| | K97BN | Touch Toe | Brushed Nickel | | K99CP | Push & Pull | Chrome |
| | K97RB | Touch Toe | Oil Rubbed Bronze | | K99BN | Push & Pull | Brushed Nickel |
| | K97BG | Touch Toe | Brushed Gold | | K99RB | Push & Pull | Oil Rubbed Bronze |
| | K98CP | Uni-Lift | Chrome | | K99WH | Push & Pull | White |
| | K98BN | Uni-Lift | Brushed Nickel | | K99MB | Push & Pull | Matte Black |
| | K98RB | Uni-Lift | Oil Rubbed Bronze | | K99BG | Push & Pull | Brushed Gold |

Access BIM/Revit content through www.oatey.com