



Job Name _____	Item # _____
Location _____	
Engineer _____	Contractor _____
PO # _____	Tag _____
Representative _____	

# 1-1/2 IN. X 16 IN. BLACK PLASTIC DOUBLE SLIP-JOINT SINK DRAIN TAILPIECE EXTENSION TUBE TECHNICAL SPECIFICATION

## SPECIFICATIONS

1-1/2 in. x 16 in. Slip Joint Extension Tube features a black finish for an attractive appearance. This extension tube is made for tubular drain applications. The double-ended design allows for use as is or to be cut. Constructed of polypropylene for durability. Oatey products have earned the trust of plumbing professionals for over 100 years.

## APPROVALS AND LISTINGS



## DIMENSIONS

[A]:	1.545"
[B]:	1.50"
[C]:	16.0"
[D]:	1 1/2-11.5 NPSM

## PRODUCT SELECTOR

✓	Product Number	Description	Ctn. Wt.	Ctn. Qty.
	HDCA9793E	1-1/2 in. x 16 in. Black Plastic Double Slip-Joint Sink Drain Tailpiece Extension Tube	2.775 lbs.	12

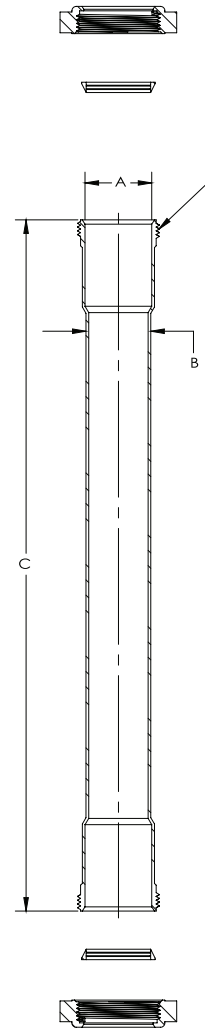

Access BIM/Revit content through [www.oatey.com](http://www.oatey.com)