



Job Name _____	Item # _____
Location _____	
Engineer _____	Contractor _____
PO # _____	Tag _____
Representative _____	

1-1/4 IN. X 6 IN. CHROME-PLATED BRASS DOUBLE THREADED-JOINT SINK DRAIN TAILPIECE EXTENSION TUBE TECHNICAL SPECIFICATION

SPECIFICATIONS

1-1/4 in. x 6 in. Threaded-Joint Extension Tube is used to extend your sink or bath tub drain. It's threaded on both ends for quick installation. The brass construction provides durability, while the chrome plating offers a sleek look. Dearborn is known for providing superior quality plumbing products designed with the plumber in mind.

APPROVALS AND LISTINGS



DIMENSIONS

[A]:	1.25"
[B]:	6.00"
[C]:	1.26-27UNS-2A

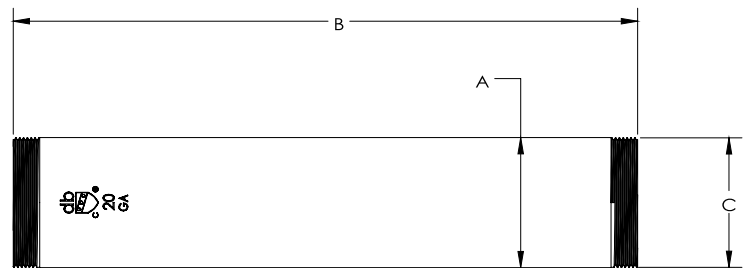

PRODUCT SELECTOR

✓	Product Number	Description	Ctn. Wt.	Ctn. Qty.
	HDC819-1	1-1/4 in. x 6 in. Chrome-Plated 20-Gauge Brass Double Threaded-Joint Sink Drain Tailpiece Extension Tube	1.5 lbs.	8

Access BIM/Revit content through www.oatey.com