



Job Name _____	Item # _____
Location _____	
Engineer _____	Contractor _____
PO # _____	Tag _____
Representative _____	

1-1/2 IN. X 15 IN. WHITE PLASTIC SLIP-JOINT SINK DRAIN OUTLET WASTE ARM TECHNICAL SPECIFICATION

SPECIFICATIONS

The 1.5 in. x 15 in. Plastic Tubular Waste Arm features polypropylene plastic construction and the option for either slip joint or direct connection. Designed for use in tubular drain applications. Oatey products have earned the trust of plumbing professionals for over 100 years.

APPROVALS AND LISTINGS



DIMENSIONS

[A]:	1.50"
[B]:	1.51"
[C]:	15"
[D]:	0.69"
[E]:	1.50"
[F]:	1.72"
[G]:	1.25"
[H]:	1 1/2-11.5NPSM

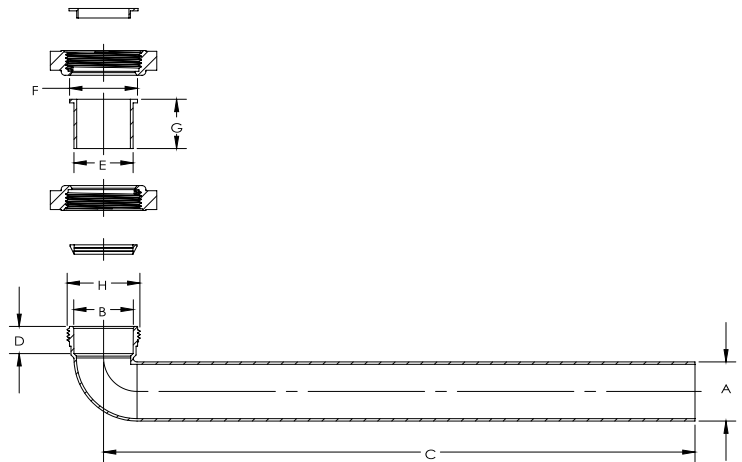

PRODUCT SELECTOR

✓	Product Number	Description	Ctn. Wt.	Ctn. Qty.
	HDC2690B	1-1/2 in. x 15 in. White Plastic Slip-Joint Sink Drain Outlet Waste Arm	3 lbs.	12

Access BIM/Revit content through www.oatey.com