



1-1/2" DOUBLE SLIP JOINT TRAP OFFSET TECHNICAL SPECIFICATION

Job Name _____	Item # _____
Location _____	
Engineer _____	Contractor _____
PO # _____	Tag _____
Representative _____	

SPECIFICATIONS

Dearborn 1-1/2" Brass Tubular Double Slip Joint Trap Offset is designed for use in tubular drain applications. Available in 17 or 20 Gauge Brass. Options include Brass Nuts.

DESCRIPTION

- Chrome Finish
- Double Slip Joint Trap Offset:
 - (1) 1-1/2" Trap Offset
 - (2) Nuts
 - (2) Rubber Washers



DIMENSIONS

[A]:	Length A	1.5"
[B]:	Height B	9.125"
[C]:	Length C	5.38"

PRODUCT SELECTOR

BRASS TUBULAR FLANGED STRAINER TAILPIECES				
✓	Product Number	Size	Description	Carton Quantity
	1046A-1	1-1/2"	Double Slip Joint Trap Offset - 20 Gauge	5
	1046A-17-3	1-1/2"	Double Slip Joint Trap Offset - 17 Gauge, Unfinished	25
	1046A-17BN-1	1-1/2"	Double Slip Joint Trap Offset with Brass Nuts - 17 Gauge	5

Data is subject to manufacturing tolerances.

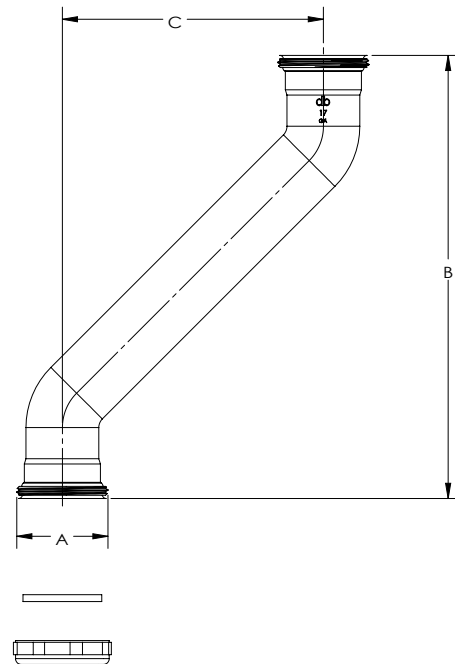

Access BIM/Revit content through www.Oatey.com