

INSTRUCTION GUIDE

BOTTLE TRAP



1 Cut tailpiece from pop-up assembly or grid drain to desired length.

2 Slide chrome nut **(A)** onto vertical tailpiece.

3 Push plastic tube **(B)** onto tailpiece to the first internal rib.

4 Slide bottle trap **(C)** up against the top of the plastic tube **(B)** and handtighten chrome nut **(A)** onto the bottle trap **(C)**.

5 Measure and cut waste arm **(F)** to desired length.

6 Place bottle trap slip washer **(D)** and chrome slip nut **(E)** onto waste arm **(F)**.

7 Place escutcheon plate **(G)**, existing slip nut and slip washer onto waste arm **(F)**.

8 Slide waste arm **(F)** into wall trap adaptor first and handtighten slip nut.

9 Slide waste arm **(F)** into the bottle trap **(C)**.

10 Tighten all nuts to create a water tight seal and **CHECK FOR LEAKS**.

NOTE: Bottle trap clean out is located at the bottom of **(C)**. Insert flathead screwdriver into slot on clean out cap. Rotate counterclockwise until cap releases. Remove O-ring and any debris. Clean O-ring and cap before replacing. Tighten cap. **CHECK FOR LEAKS**.

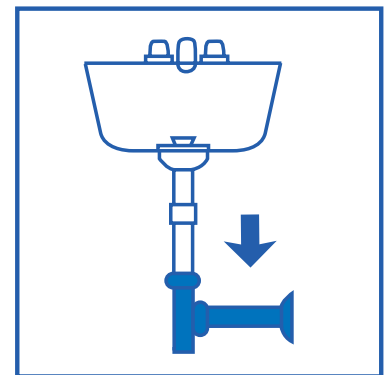
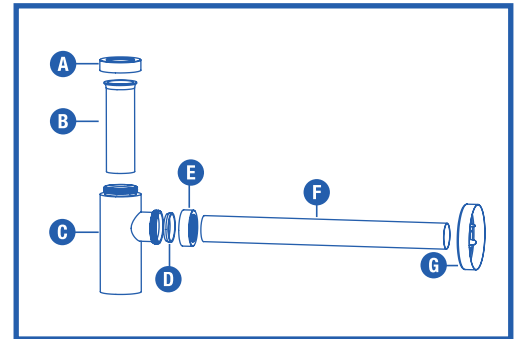

©2023 Oatey SCS. All Rights Reserved. This information is based on data believed to be reliable but Oatey makes no warranties, express or implied, as to its accuracy and assumes no liability arising out of its use. The data listed falls within the normal range of product properties but should not be used to establish specification limits or used alone as the basis of design. Oatey's liability to purchasers is expressly limited to the terms and conditions of sale. Oatey is trademark of Oatey Co. All other trademarks can be found www.Oatey.com.